

PB05 Fast Acting SMD 125VAC/DC Fuses

PB05 Series



Description

PB05 SMD fuse for the small size and good electrical performance, reliability and quality.

Electrical Characteristics		
Rated Current	1.0In	2.0In
500mA~1.5A	4 hour minimum	120S Maximum
2A~15A	4 hour minimum	5sec maximum

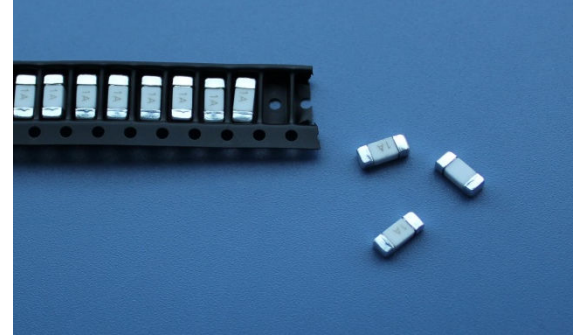

Features

- Designed to UL 248-14
- Compatible with reflow and wave soldering
- One time positive disconnect
- RoHS compliant

Specification								
Part No.	Rated Voltage		Rated Current (A)	Breaking Capacity (A) ¹		Typical Cold Resistance (mOhms) ²	Typical Voltage Drop (mV)	Typical Pre-Arcing I ² t (A ² Sec) ³
	AC	DC		125VAC	125VDC			
	PB05.0.5	125V	125V	500mA	50A			
PB05.0.8	800mA			306		370	0.51	
PB05.1	1A			256		360	0.85	
PB05.1.5	1.5A			188		300	0.83	
PB05.2	2A			27.9		96	1	
PB05.3	3A			17.8		86	3	
PB05.4	4A			12.9		85	5	
PB05.5	5A			10.2		81	7	
PB05.6.3	6.3A			7.93		80	12	
PB05.7	7A			7.23		80	19	
PB05.8	8A			6.39		78	23	
PB05.10	10A			4.6		77	35	
PB05.12	12A			4.08		76	55	
PB05.15	15A			3.15		75	98	

1. AC Interrupting Rating (measured at designated voltage, 100% power factor); DC Interrupting Rating (measured at designated voltage, time constant of less than 50 microseconds, battery source)

2. DC Cold Resistance are measured at <10% of rated current in the ambient temperature of 25°C

3. Typical Pre-arcing I²t are measured at 10In Current

Dimension

Drawing not to scale (Unit: mm)

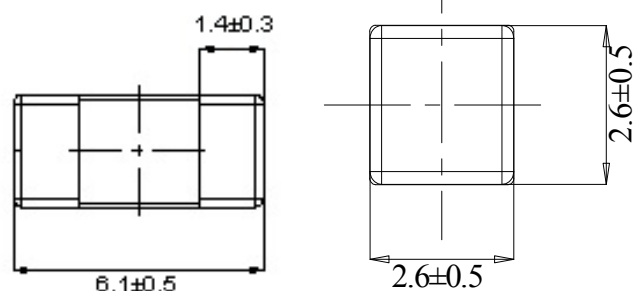

PB05 Fast Acting SMD 125VAC/DC Fuses

PB05 Series



Time-Current Curves

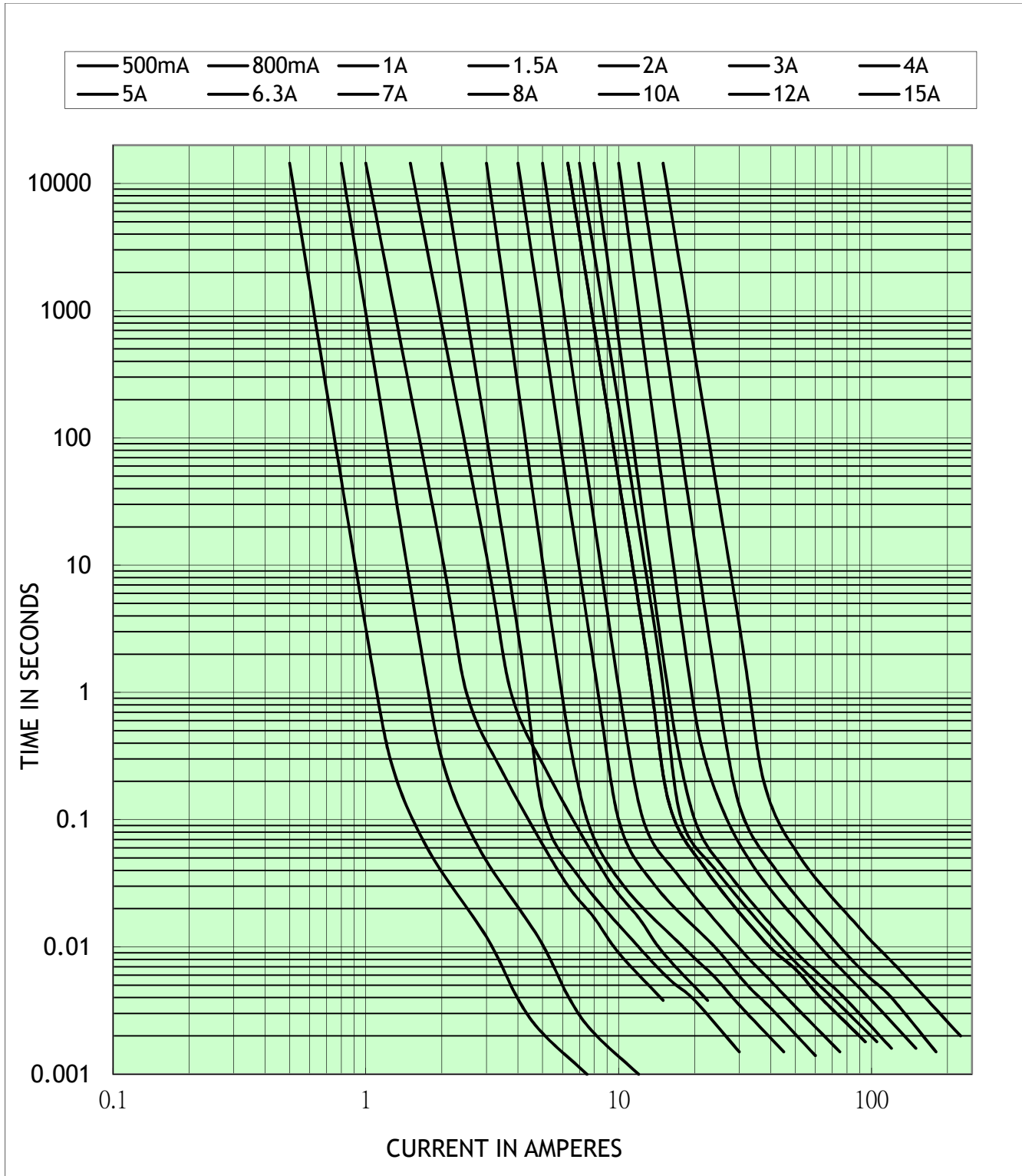

PB05 Fast Acting SMD 125VAC/DC Fuses

PB05 Series



Soldering method

- Recommended land pattern (mm)

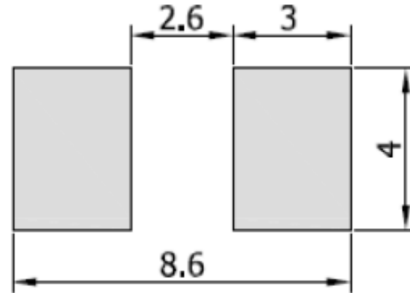

- Wave solder
 - Reservoir temperature: 260°C
 - Time in reservoir: 5 seconds maximum
- Infrared reflow
 - Temperature: 260°C
 - Time: 10 seconds maximum

Solder reflow profile

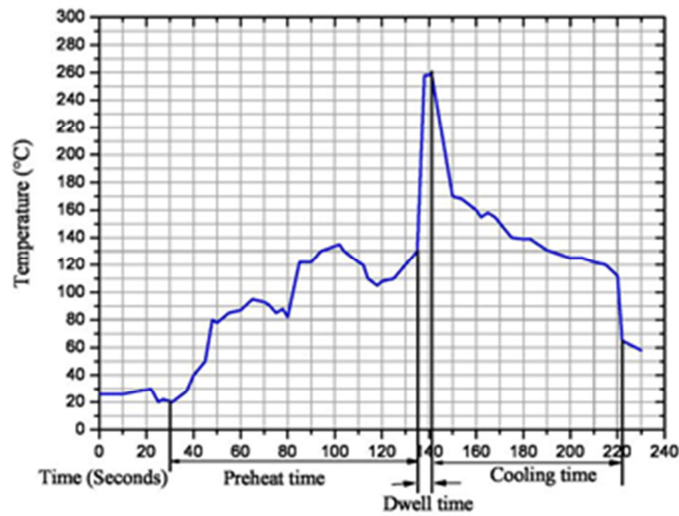

PB05 Fast Acting SMD 125VAC/DC Fuses

PB05 Series



Temperature Derating Curve

Normal ambient temperature: 23+/-3°C

Operating temperature: -40°C ~ 125°C, with proper correction factor applied

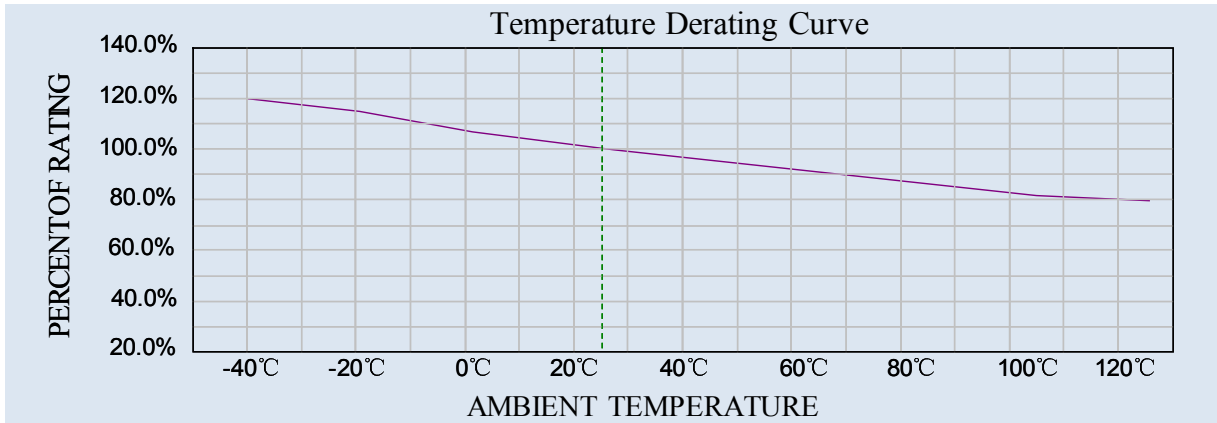

Package

1000 fuses on 12mm tape-and-reel per EIA Standard 481.

--- End of Document ---